

**MIDDLE SCHOOL**

**SCOTT DYER ROAD**

**MIDDLE SCHOOL ENTRY**

**ELEMENTARY SCHOOL ENTRY**

**ELEMENTARY SCHOOL**

**ME-77**

*1994  
Two Story  
(Demo in option E)*

*1960*

*1955*

*1955*

*1934*

*1994  
Maintain  
For ES*

*1994  
Single Story  
(Demo in option E)*

*1994  
Maintain For ES*

*1962*

*1960*

*1952*

*1948*

*2004*

## Program proportional distribution:

Admin	10%
Aux	5%
Classroom	28%
Egress	25%
Fine Arts	23%
Special Serv	7%
District Program	3%
	100%

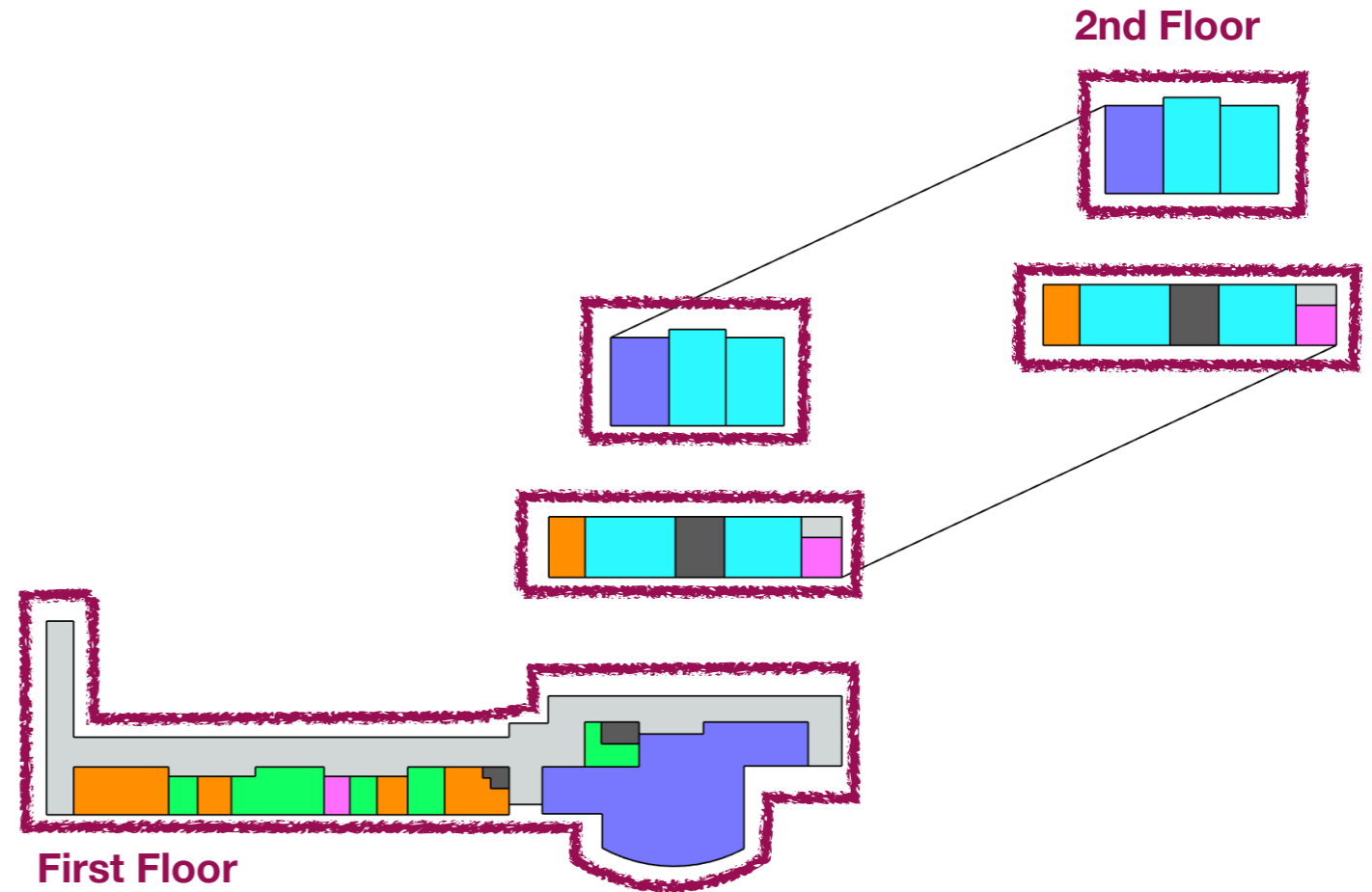

## OBSERVATIONS:

- Hallway/egress space makes up about 1/4 of the total 1994 additions that would be demolished in option E. That a lot of square footage that is not providing academic value, and contributes to the sprawl issue that we know well.
- We know that the classrooms in the 1994 additions are undersized, and interior walls are constructed of CMU block, so are very difficult to adjust.
- We know that the layout of the existing MS admin is not ideal - a string of offices and small spaces along a long hallway does not allow staff to easily communicate privately, and students waiting for services must sit in the hall.

\*Note: these percentages are approximate as they have been scaled off of Harriman's recent existing plan pdf. Wall thickness and are not accounted for. However, the relational proportions of program spaces should be close to actual.